

Z:\15\15-16-216\15-16-216_NC14-1.dwg

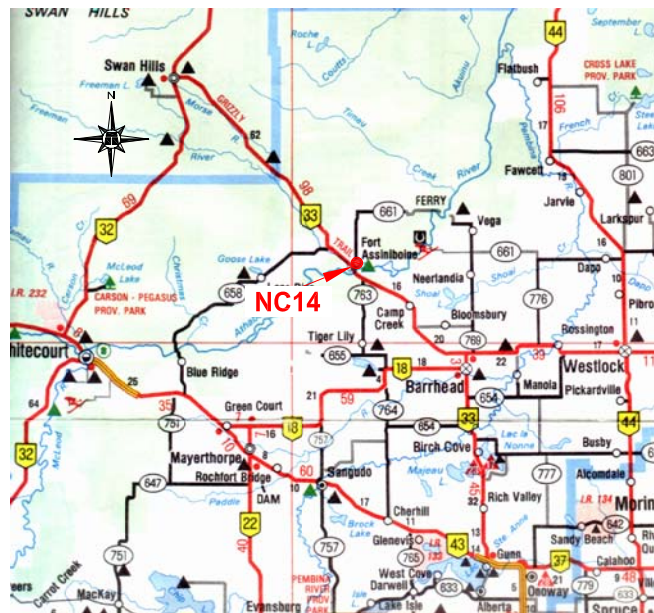

KEY MAP
N.T.S.

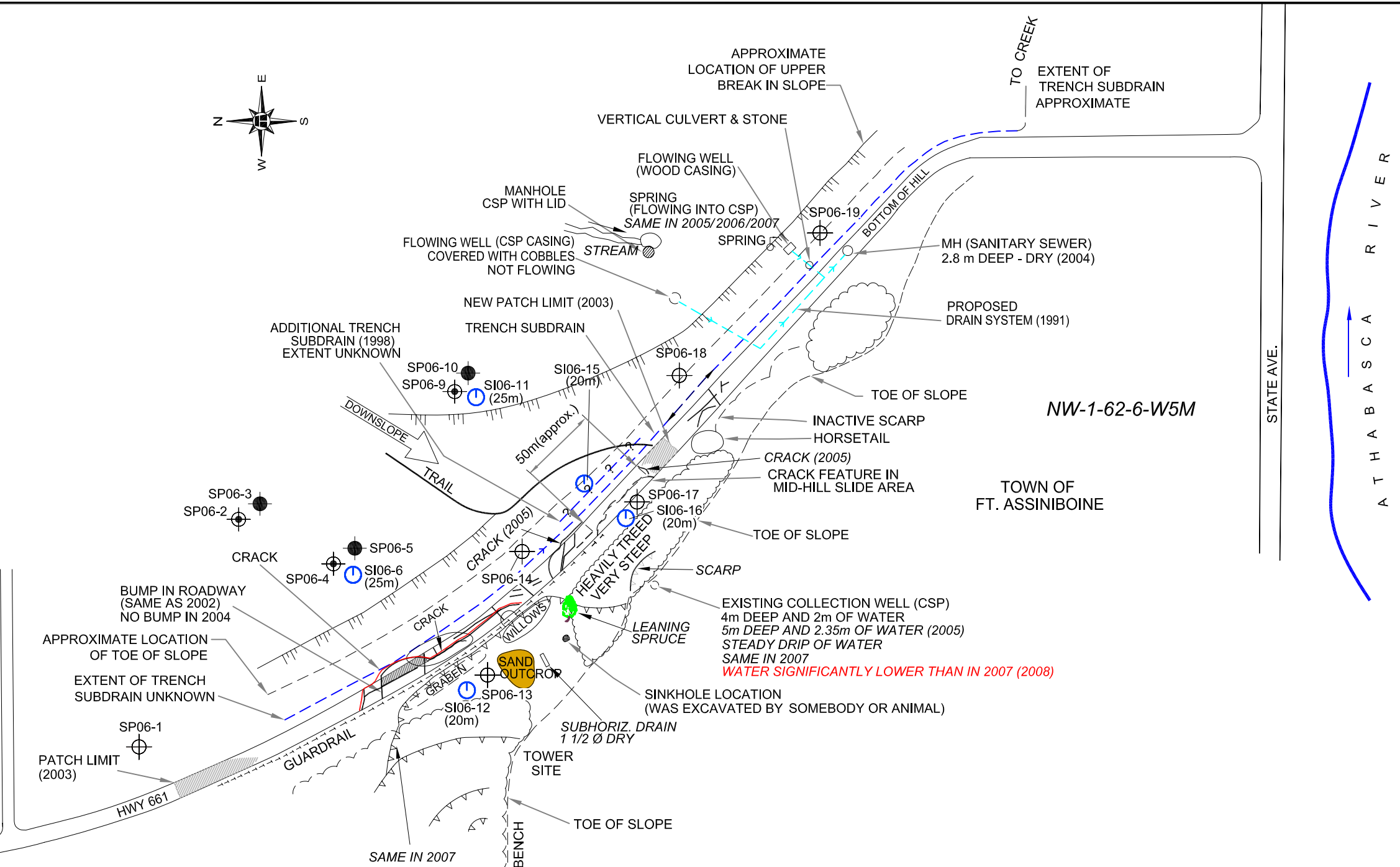
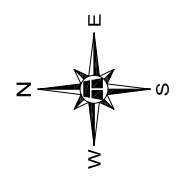

- LEGEND**
- ASPHALT PATCH
 - ASPHALT PATCH (2004)
 - SI (_m) SLOPE INCLINOMETER AND DEPTH
 - SP STANDPIPE PIEZOMETER (25m DEPTH)
 - SP STANDPIPE PIEZOMETER (15m DEPTH)
 - SP STANDPIPE PIEZOMETER (10m DEPTH)

MR. CARTWRIGHT PROPERTY

- NOTES**
1. FEATURE LOCATIONS ARE APPROXIMATE.
 2. PREVIOUS OBSERVATIONS SHOWN IN BLACK
 3. **JUNE, 2008 OBSERVATIONS SHOWN IN RED**

BASE PLAN FROM THURBER ENGINEERING REPORT 15-16-192

THURBER PROJECT #15-16-216

ALBERTA TRANSPORTATION

**SITE PLAN SHOWING
2006 INSTRUMENTATION LOCATIONS**

NORTH CENTRAL (ATHABASCA) 2008
GEOHAZARD ASSESSMENTS

NC14 - HWY 661:02 km1.8
NW-1-62-6-W5M
N. OF FT. ASSINIBOINE, AB

THURBER ENGINEERING LTD.
GEOTECHNICAL • ENVIRONMENTAL • MATERIALS

ENGINEER:	DRAWN:	APPROVED:	
EDG	CMH	DJL	
DATE:	SCALE:	DRAWING No.	
JUNE, 2008	APPR. SCALE 1:3,000	FIGURE NC14-1	

Z:\15\15-16-21\15-16-216_NC14-2.dwg

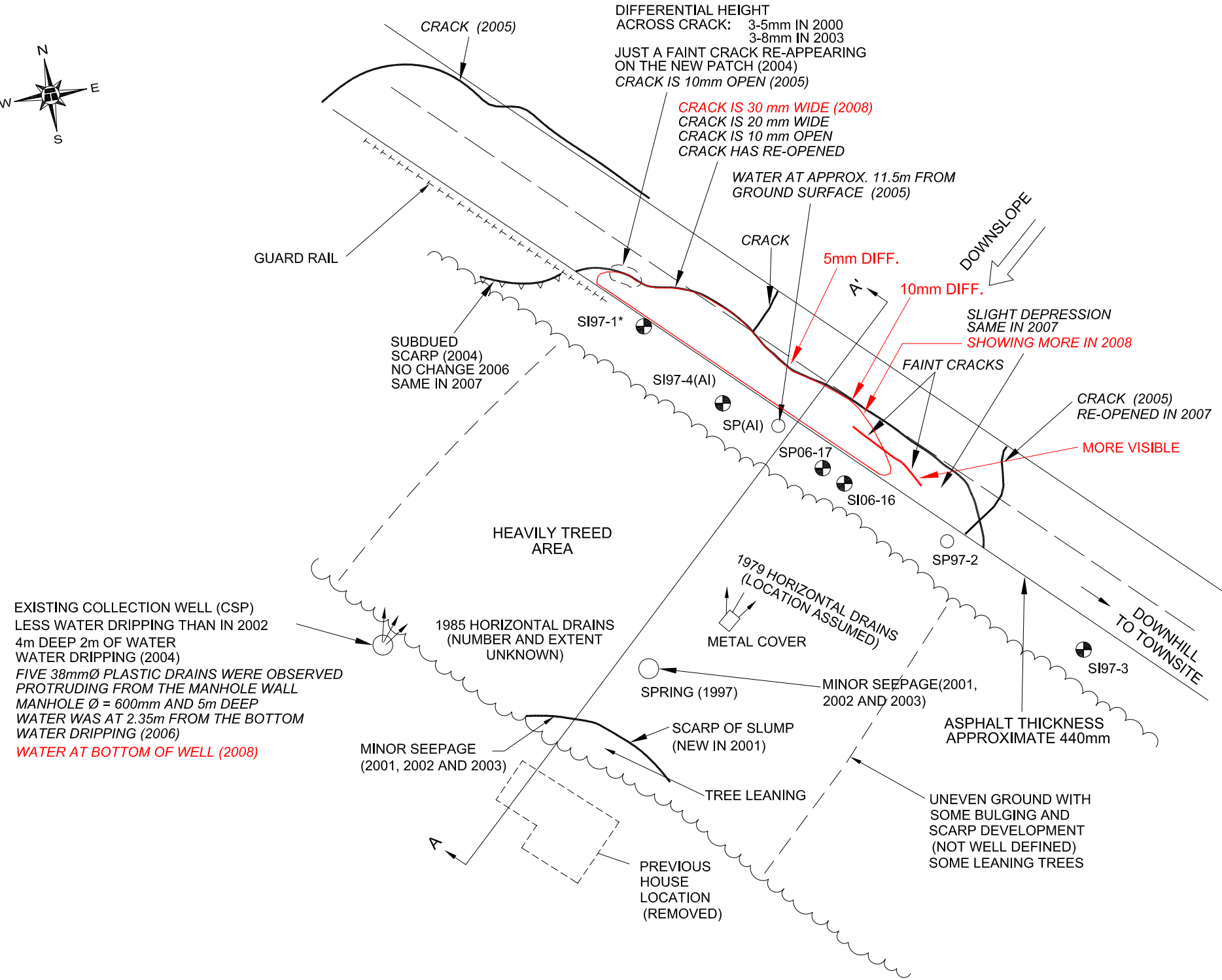
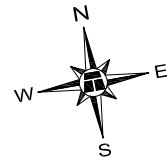

NOTES :

1. FEATURE LOCATIONS ARE APPROXIMATE.
2. PREVIOUS OBSERVATIONS SHOWN IN BLACK
3. PREVIOUS CRACK PATTERN WAS COVERED BY NEW (2004) ASPHALT PATCH
4. JUNE, 2008 OBSERVATIONS SHOWN IN RED

LEGEND

- SI - SLOPE INCLINOMETER
- SP - STANDPIPE PIEZOMETER

THURBER PROJECT #15-16-216

ALBERTA TRANSPORTATION

**SITE PLAN
MID-HILL SLIDE AREA**

NORTH CENTRAL (ATHABASCA) 2008
GEOHAZARD ASSESSMENTS

NW-1-62-6-W5M
NC14 - HWY 661:02 km1.8
N. OF FT. ASSINIBOINE, AB



THURBER ENGINEERING LTD.
GEOTECHNICAL ■ ENVIRONMENTAL ■ MATERIALS

ENGINEER :	EDG	DRAWN :	CMH	APPROVED :	DJL
DATE :	JUNE, 2008	SCALE :	NOT TO SCALE	DRAWING No. :	FIGURE NC14-2