



**ALBERTA TRANSPORTATION
NORTH CENTRAL REGION – ATHABASCA AREA
INSTRUMENTATION MONITORING RESULTS**

FALL 2012

**SECTION D
DATA PRESENTATION**

SITE NC14: HWY 661:02 FORT ASSINIBOINE

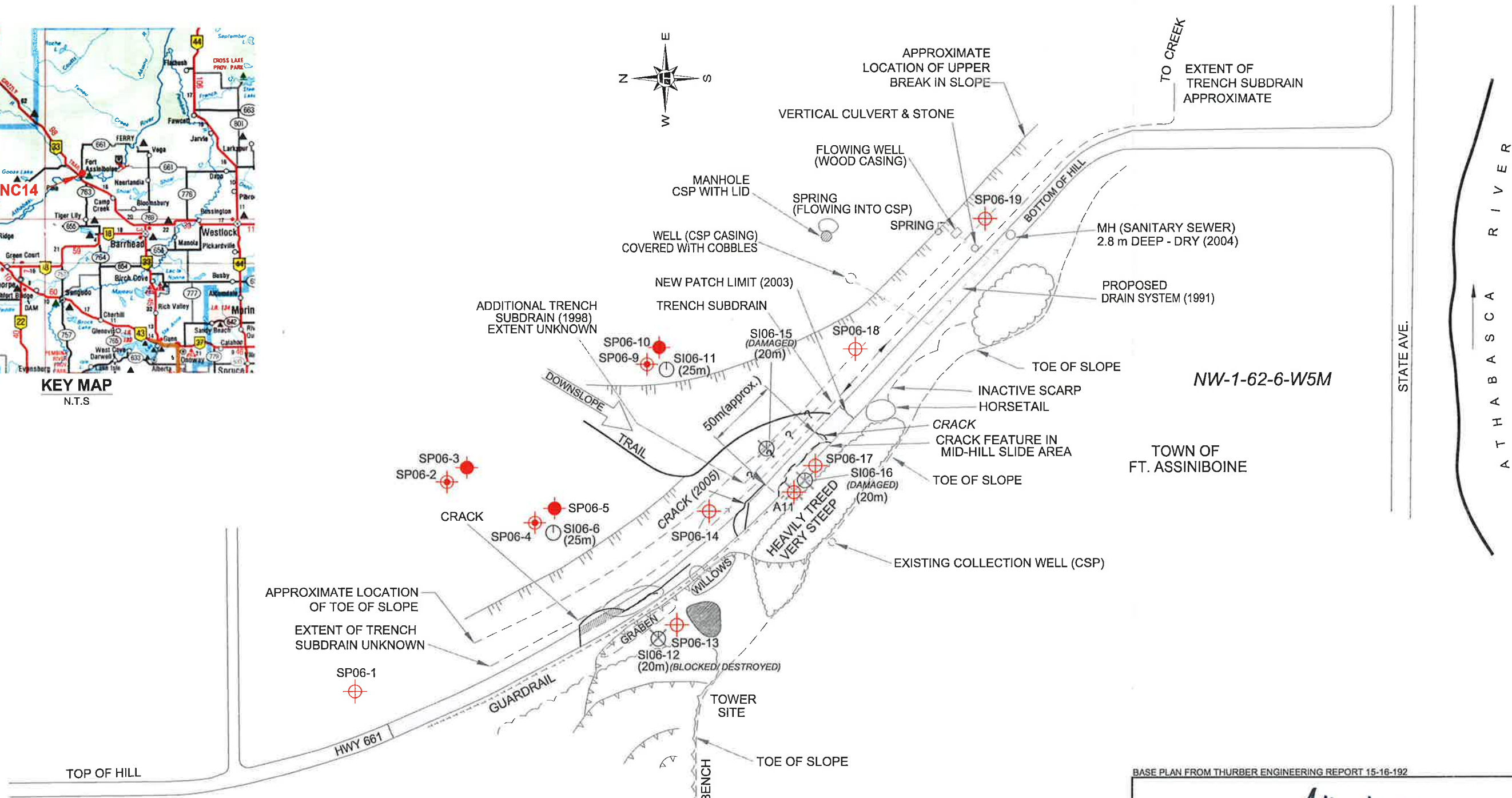
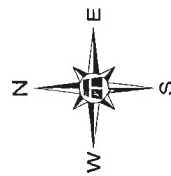
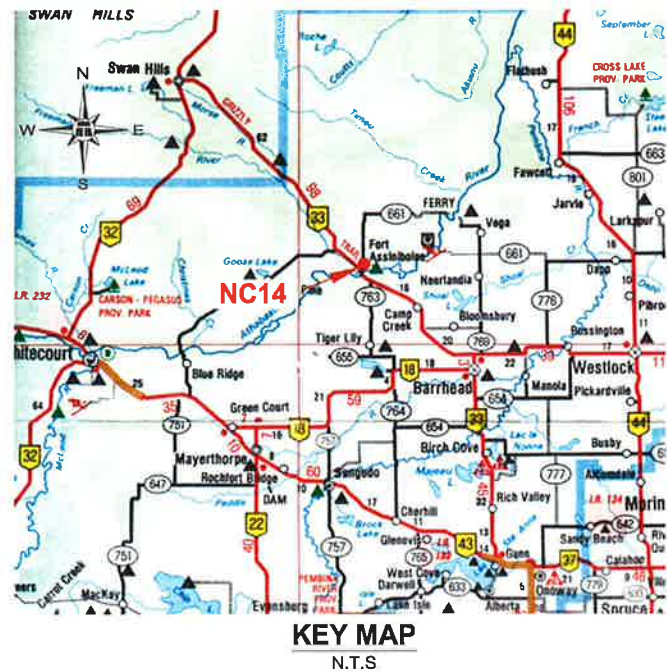

LEGEND

- ⊙ SI (m) SLOPE INCLINOMETER AND DEPTH
- SP STANDPIPE PIEZOMETER (25m DEPTH)
- ⊕ SP STANDPIPE PIEZOMETER (15m DEPTH)
- ⊕ SP STANDPIPE PIEZOMETER (10m DEPTH)
- ⊗ SI SLOPE INCLINOMETER NON OPERATIONAL
- ⊗ SP STANDPIPE PIEZOMETER NON OPERATIONAL

□ MR. CARTWRIGHT PROPERTY



BASE PLAN FROM THURBER ENGINEERING REPORT 15-16-192



NORTH CENTRAL REGION - ATHABASCA AREA

**NC14 - FORT ASSINIBOINE
INSTRUMENT LOCATIONS**

DWG No. 15-16-274-NC14

DRAWN BY	KLW
DESIGNED BY	NFR
APPROVED BY	DWP
SCALE	1:3000
DATE	OCTOBER 2012
FILE No.	15-16-274



Thurber Engineering Ltd. - Edmonton, AB

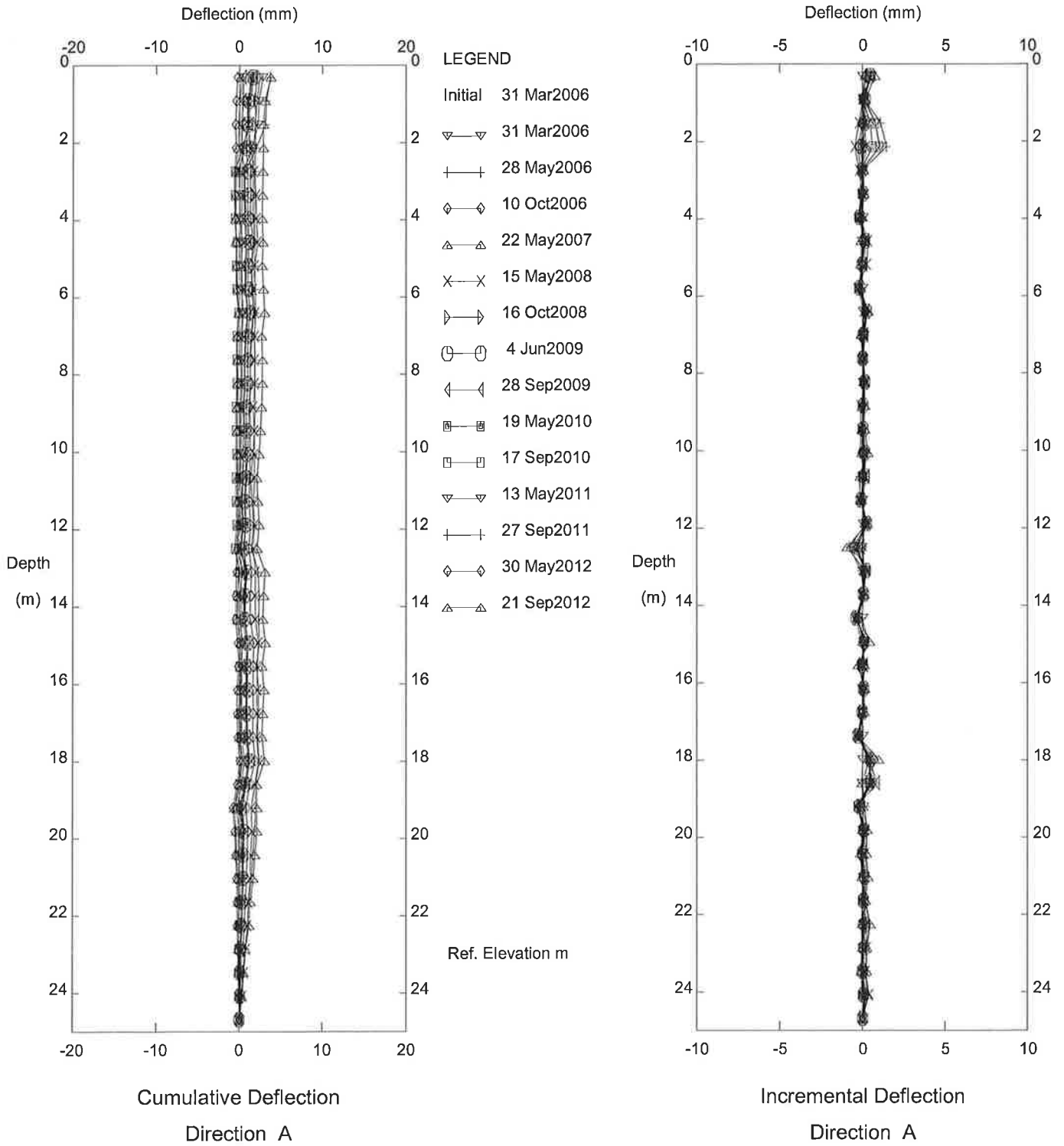

Hwy 661:02 Ft Assiniboine (NC14), Inclinator SI06-6

Alberta Transportation

Thurber Engineering Ltd. - Edmonton, AB

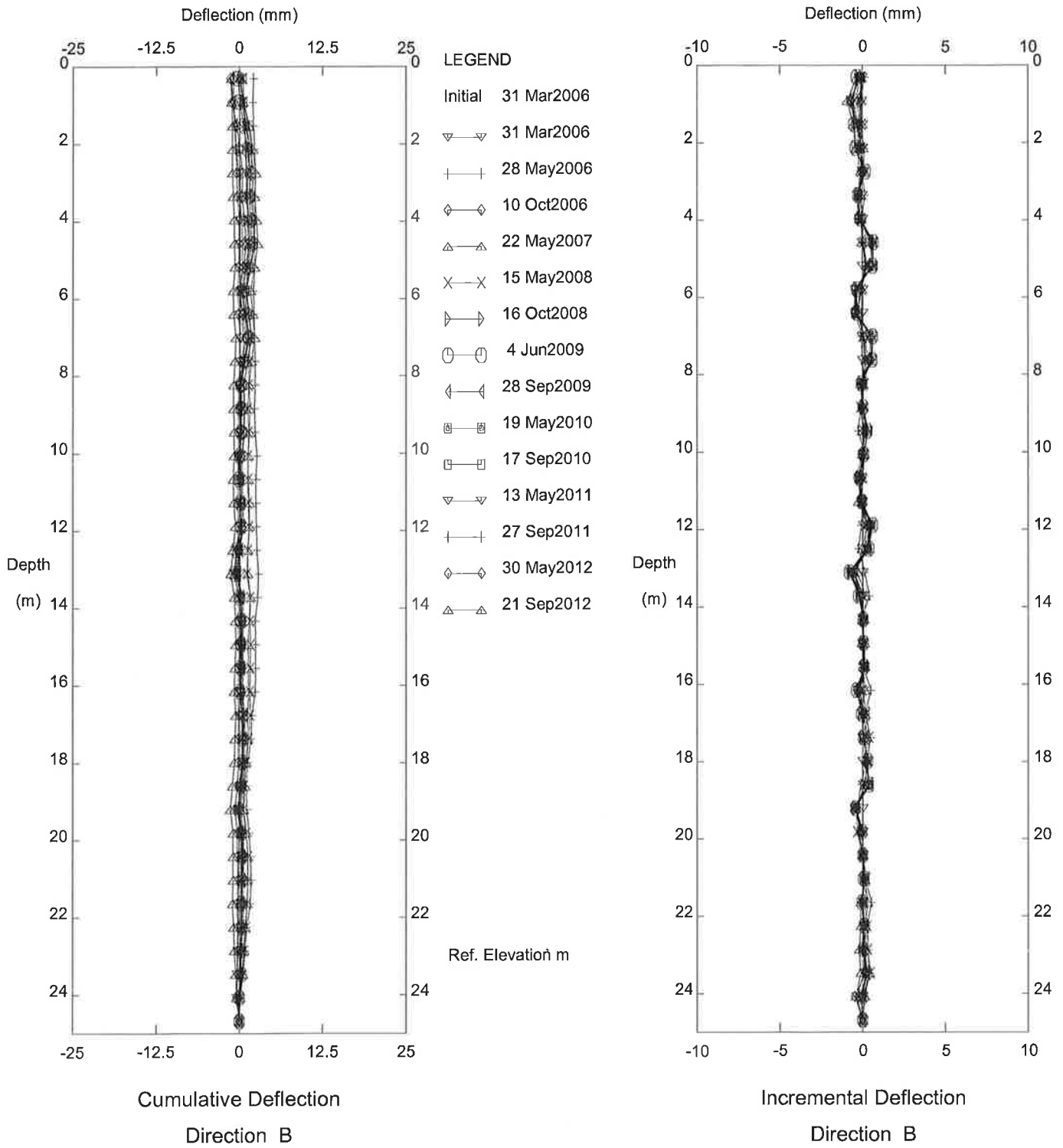

Hwy 661:02 Ft Assiniboine (NC14), Inclinator SI06-6

Alberta Transportation

Thurber Engineering Ltd. - Edmonton, AB

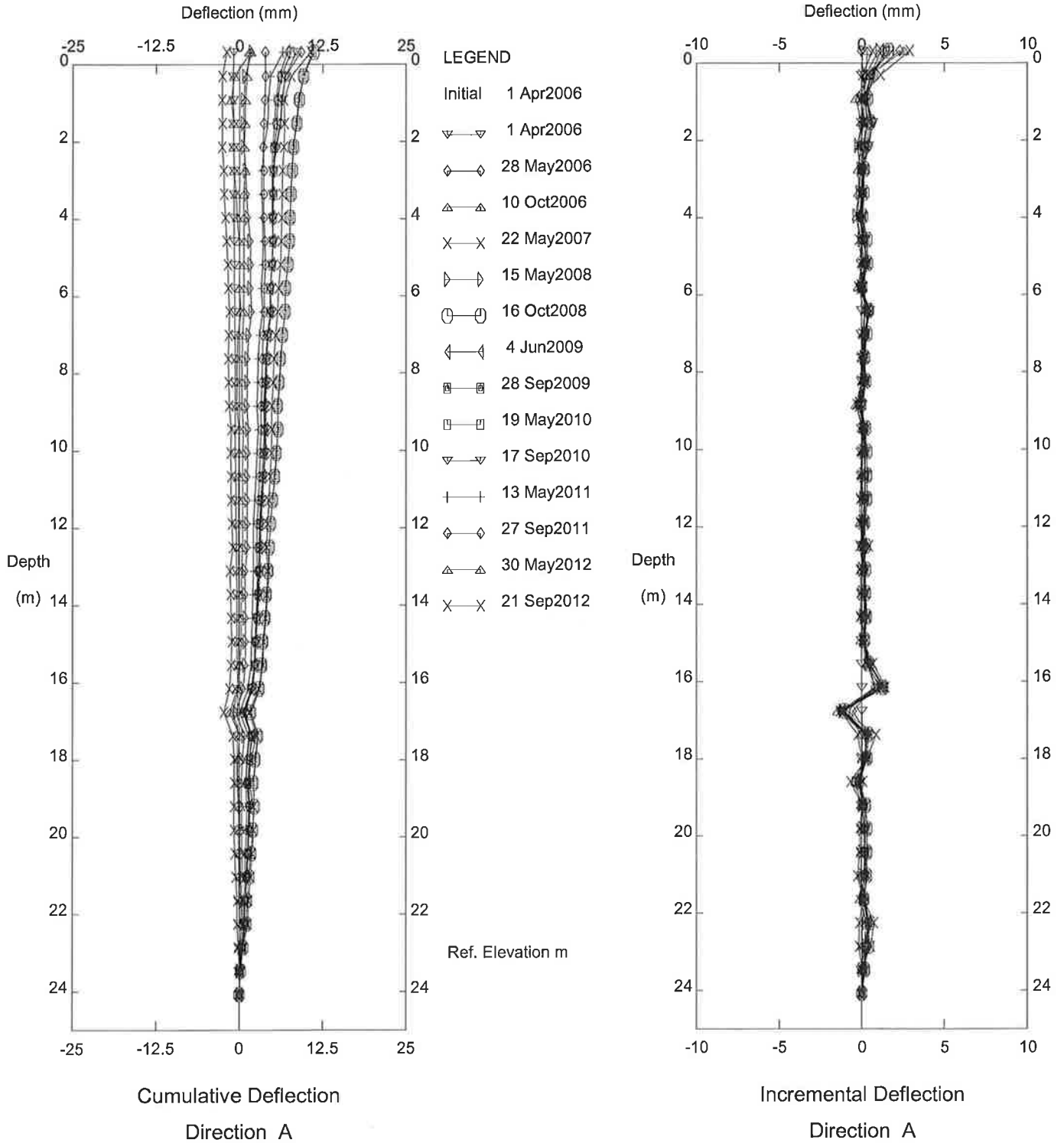

Hwy 661:02 Ft Assiniboine (NC14), Inclinometer SI-11

Alberta Transportation

Thurber Engineering Ltd. - Edmonton, AB

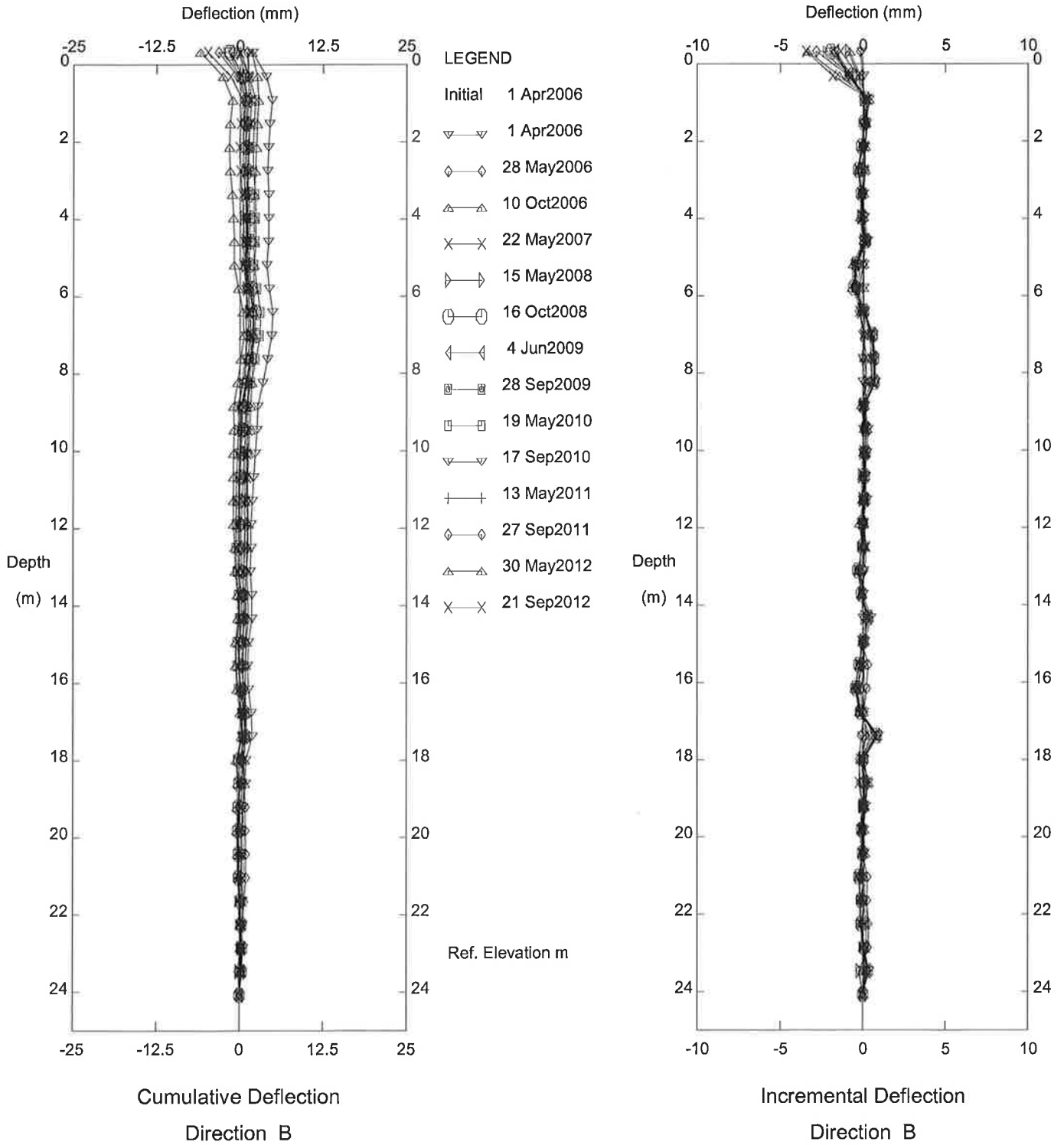

Hwy 661:02 Ft Assiniboine (NC14), Inclinometer SI-11

Alberta Transportation

HWY661:02 FORT ASSINIBOINE (NC14) - STANDPIPE DATA WATER TABLE DEPTH

